

Dear Readers,

In the historical days of computerization in India there were various conflicts for its implementation. These conflicts resulted in worker strikes and various forms of oppositions. Even then, computerization made its way in every walk of life.

Similarly the AEC industry is passing through BIM implementation. Yes! there will be teething trouble. People are not receptive to change whether it olden days or today. History has proved that there has always been strong opposition for change.

BIM has not stopped its implementation be it in west or east. Now that the government is insisting for BIM implementation, it is in the interest of every AEC firm, that they use BIM services as it is no more a **good to have service**, but a **must have service**



Sonali Dhopte
(Director Excelize)
sonali@excelize.com

★ The Buzz...

Celebration of 8th Foundation Day on 6th September 2012.

8 years ago on 6th September 2004 we started operations of Excelize India. We were then 7-8 people and today are about 60+ strong.

I look forward with a lot of optimism and hope to the journey ahead. On the journey thus far, I have had a great time and a wonderful learning experience. I believe that in some small ways we have enriched the life of our co-travellers and contributed something valuable to our clients, our team members and society at large. Much still remains to be done and I feel energized to do that.

The Excelizians Saying their Mission Statement.....



www.excelize.com is now more useful and friendly with interesting articles, newsletters, portfolio samples, testimonials and more.



Ongoing Projects at Excelize

PROJECT SAMPLE

BLDG-1 - SOUTH (PLANNED - vs - ACTUAL)



11 MAY 2012

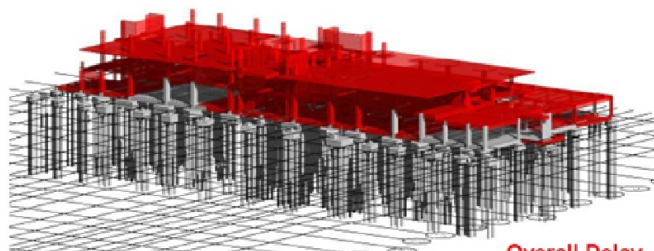

Planned Status

Grade Slab & Beams - 100%

Podium Slab & Beams - 100%

FF Slab & Beams - 100%

Second Floor - 30%

Actual Status

Grade Slab & Beams - 100%

Podium Slab & Beams - 12%

FF Slab & Beams - 0%

Second Floor - 0%

Overall Delay - 34 Days

| | |
|----------------------|---|
| On Schedule | ■ |
| Ahead of schedule | ■ |
| Behind schedule | ■ |
| Concreting completed | ■ |

BIM - 4D implementation on an IT Park project in India

Excelize is working as a BIM consultant for an IT Giant in India on a couple of their IT park projects in the Eastern and Western part of the country. The scope on this project was to provide complete BIM support from design development stage through construction and post construction stage. It included 3D, 4D, 5D and support in Facilities Management & as built.

Currently this project is in construction stage and implementing BIM on this project has helped in many ways. As a part of 3D, clash identification and resolution has helped in keeping the construction process smooth and facilitate the services installation so as to achieve the targeted completion date. The quantities extracted from BIM were used to compare against the actual consumption during construction so as to monitor the material flow during construction and validating the RA bills submitted by the contractor.

4D helped the project to track the schedule and monitor delays, eradicate sequential issues in construction and streamline the construction process. This was done by closely working with the construction team on site to make use of BIM efficiently. Monitoring the construction progress through BIM (4D) helped control the delays and work towards a catch plan for the delays.



The Technology for you

Integrating the BIM

Today's integrated team environment requires a solution that can overcome the challenges imposed by software interoperability. Converting files, waiting for downloads and spending countless hours with technical support. Added complications brought by geographically dispersed teams, different software applications and increased network security creates a further impediment to the one commodity needed, which is access to timely and accurate information. As risks for profits rise, the need becomes even greater to do more with less.

The value of integrating to each touch point will vary depending on a company's specific role. For example, an owner or program manager may be primarily interested in the touch points involving budget development, 4D schedule integration, and asset management integration. A general contractor may be interested in procurement integration, 2D drawing integration, fabrication integration and Request for Information (RFI) integration.

As the market continues to adopt both BIM and ILM methodologies, the value propositions will begin to shake out as more companies experiment with each touch point opportunity.BIM Journal



Upcoming Events

3rd Annual Tunnels & Underground Construction India 2012

Date: 12-Sept-12 to 14-Sept-12

Venue: Le Meridien, New Delhi

Delhi Build

Date: 27-SEP-12 to 30-SEP-12

Venue: Pragati Maidan, New Delhi



Contact Us Excelize Architectural Services Pvt. Ltd.

Block # 11 & 12, Electronic Sadan, Software Technology Park, MIDC, Chikalthana, Aurangabad 431210. Phone (240) 2472191 sales@excelize.com

Please let us know if you would prefer not to be contacted regarding this information, send e-mail to opt-out@excelize.com and you will not receive any further e-mails from the sender.